

# Configuring Acrobat Reader for JT plus PDF

The JT2Go Acrobat Reader plugin is able to connect JTCmd URI links in a .pdf file with an active JT2Go or Teamcenter Visualization session. The links can select and highlight models/assemblies, activate model views or select PMI entities in JT2Go or Teamcenter Visualization. Acrobat Reader configuration settings are required for the connection to work properly. This document contains the settings for Acrobat Reader 9.x, 10.x, 11.x and DC. It is important to note that Reader must be closed and opened again after making these configuration changes. Reader 11.x has specific requirements, please be sure to review this entire document.

## Acrobat Reader 9x.

Start Acrobat viewer and select Edit->preferences from the menu.

**Note:** You will need to restart the reader after you change these settings.

1. Select **Documents** from **Categories** and set the **PDF/A View Mode** to **Never**.

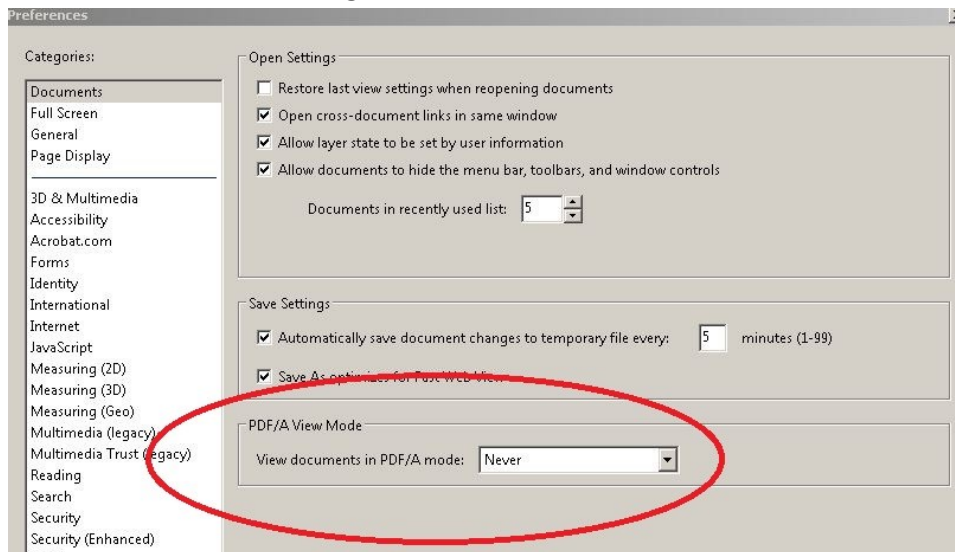

2. Select **General** from **Categories** and check **Create links from URLs**.

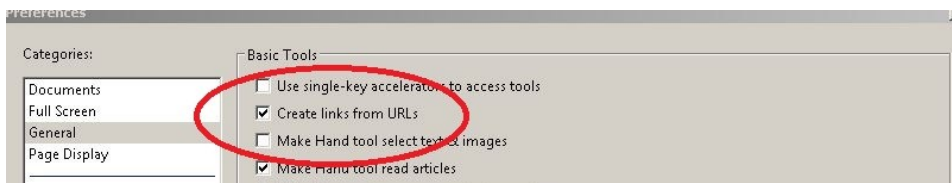

3. Select **Security (Enhanced)** from **Categories** and ensure **Enable Enhanced Security** is unchecked

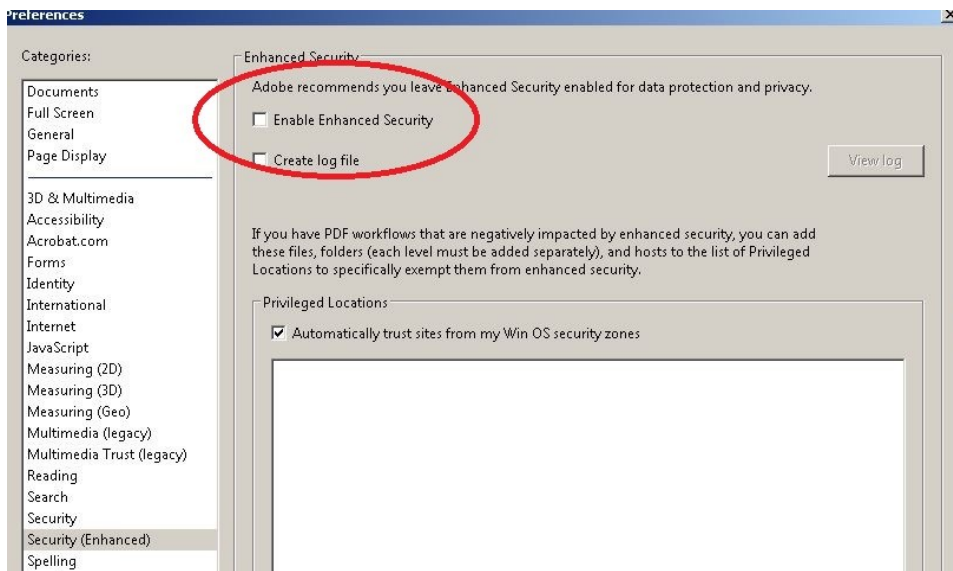

4. Select **Trust Manager** from **Categories** and check **Allow opening of non-PDF file attachments with external applications**

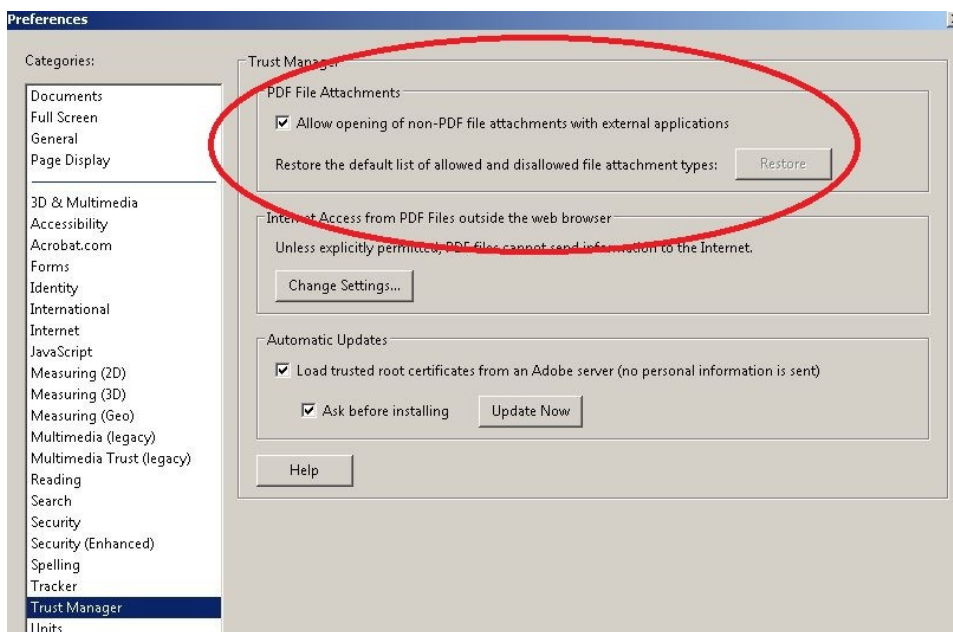

Close Acrobat viewer to save these settings.

## Acrobat Reader 10x.

Start Acrobat viewer and select Edit->preferences from the menu.

**Note:** You will need to restart the reader after you change these settings.

1. Select **Documents** from **Categories** and set the **PDF/A View Mode** is to Never.

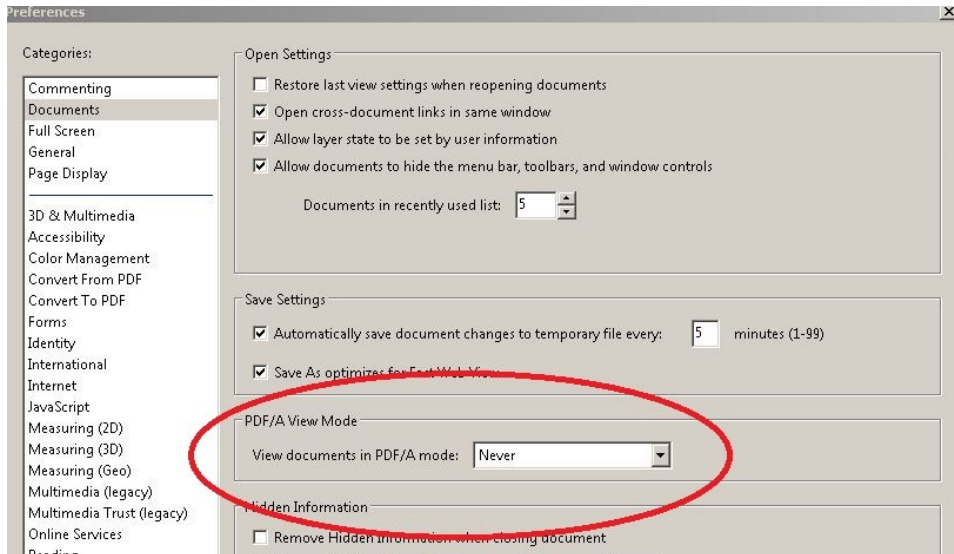

2. Select **General** from **Categories** and check **Create links from URLs**

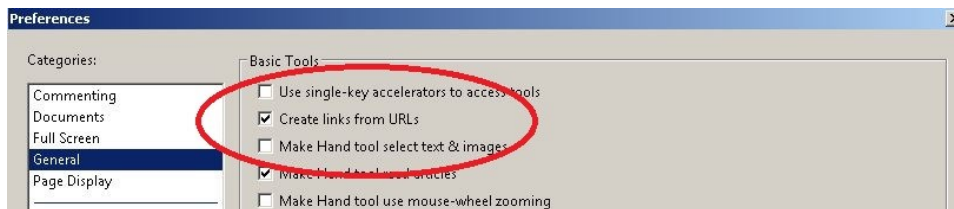

3. Select **Security (Enhanced)** from **Categories** and ensure **Enable Enhanced Security** is unchecked

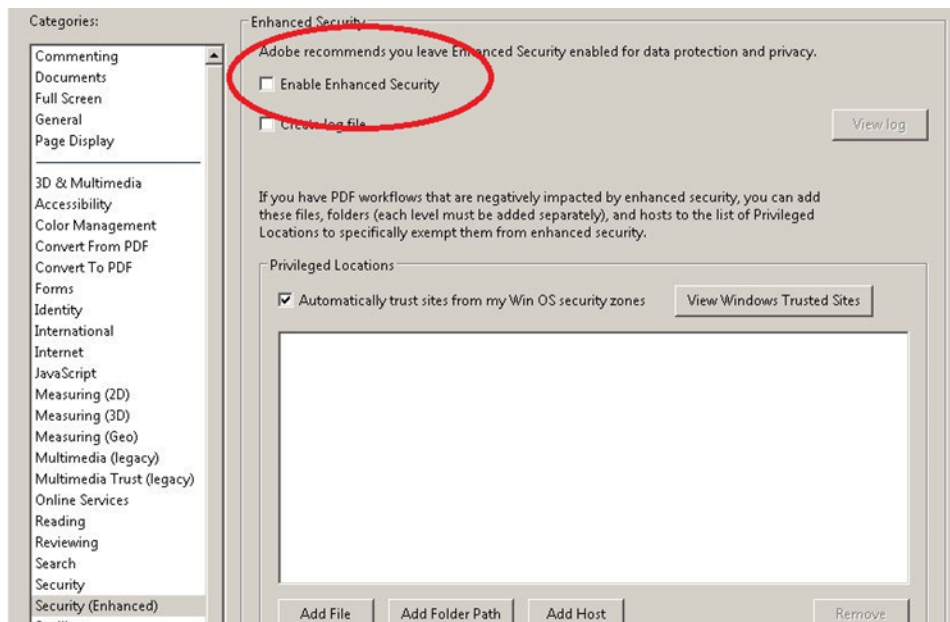

5. Select **Trust Manager** from **Categories** and check **Allow opening of non-PDF file attachments with external application**

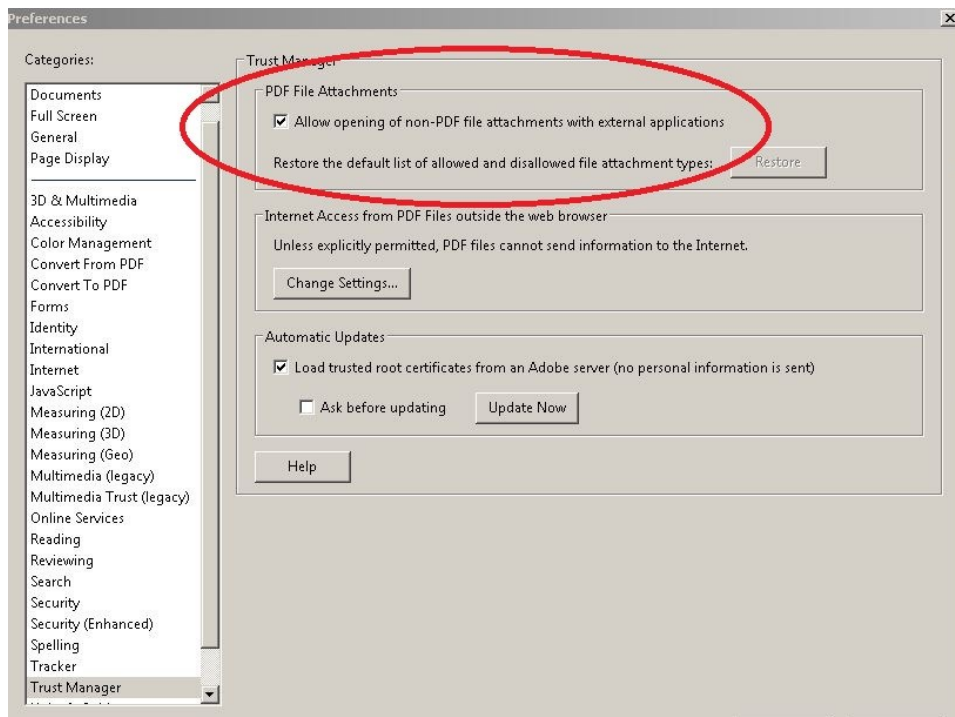

Close Acrobat viewer to save these settings.

## Acrobat Reader 11.x and DC

Starting in Acrobat 11x selecting links in a pdf document, even if they aren't web links (as in the case of our URI's to control the viewer) causes a default browser instance to be created before the link is processed by windows and forwarded to JT2GO. This appears to be due to a change made to Acrobat Reader 11x and is beyond our control. It is important that your default browser be IE or FireFox in this case, as Chrome is blocking plug-ins and will cause the uri to not be processed correctly.

Start Acrobat viewer and select Edit->preferences from the menu.

**Note:** You will need to restart the reader after you change these settings.

1. Select **Documents** from **Categories** and set the **PDF/A View Mode** is to Never

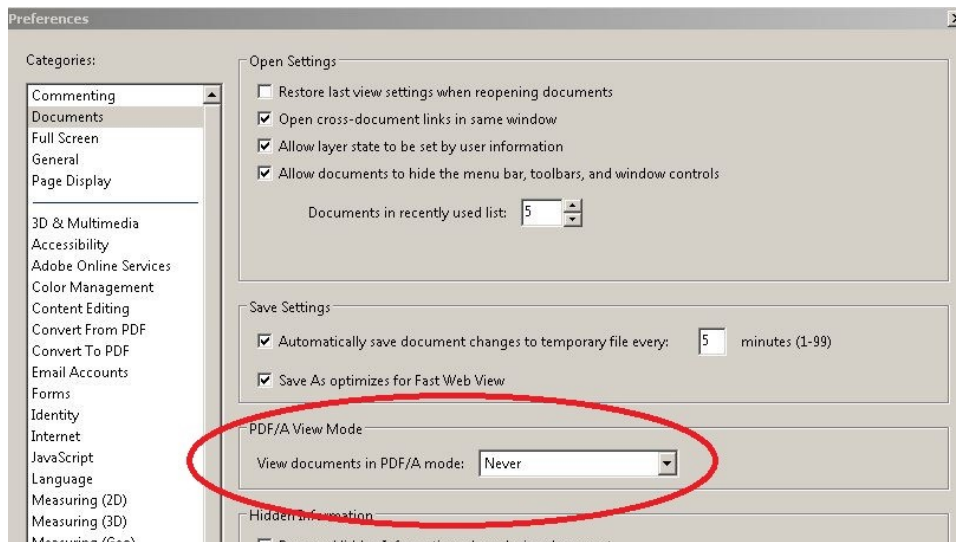

2. Select **General** from **Categories** and check **Create links from URLs**

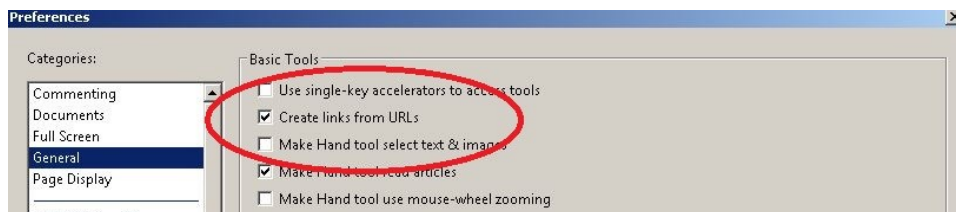

3. Select **Security (Enhanced)** from **Categories**, uncheck **Enable Enhanced Security** and **Create Protected Mode log file** then set **Protected View** to Off

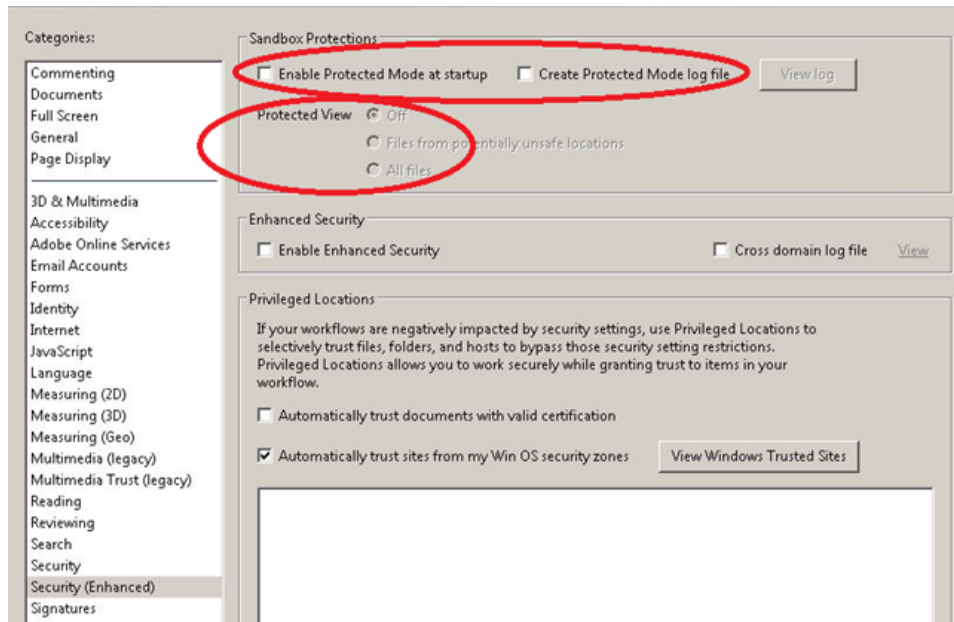

4. Select **Trust Manager** from **Categories** and check **Allow opening of non-PDF file attachments with external application**.

